

waterpik®

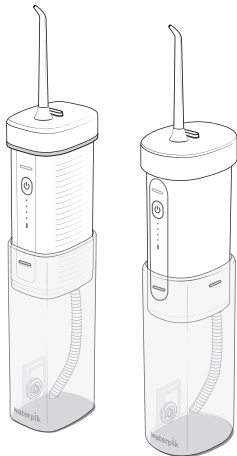

## Waterpik® Water Flosser Models WF-16 WF-17

[www.waterpik.co.uk](http://www.waterpik.co.uk)

samcooperdesign

**DO NOT PRINT**

**DATE:** 03.08.23  
**CLIENT:** WATERPIK

**FILENAME:** 20032291-F AA\_WF-16UK\_IM\_r8.indd  
**DESCRIPTION:** WF-16 UK Instruction Manual  
**LANGUAGES:** 1 (Eng)  
**FILE TYPE:** Adobe InDesign CC  
**SCD JOB# / PREPARED BY:** 22WPOH7593/ KM  
**CLIENT ROUND:** r8

**SCALE:** 100%  
**UPC:** N/A  
**SIZE:** 11 x 3.25 flat; 5.5 x 3.25 folded  
**FORM NUMBER:** 20032291-F AA  
**INK:** Process Black  
**NOTES:**

## IMPORTANT SAFEGUARDS

### READ ALL INSTRUCTIONS BEFORE USING.

- This product is for household use.

When using electrical products, especially when children are present, basic safety precautions should always be followed, including the following:

### DANGER:

#### To reduce the risk of electrocution:

- Unplug the user supplied USB wall charger when not in use.
- Do not handle the user supplied USB wall charger with wet hands.
- Do not place or drop the user supplied USB wall charger into water or other liquid.
- Check the charging cord and user supplied USB wall charger for damage before the first use and during the life of the product.

### WARNING:

#### To reduce the risk of burns, electrocution, fire, or injury to persons:

- Use this product only as indicated in these instructions or as recommended by your dental professional.
- A user supplied USB-A wall charger (power adapter), safety certified (IPX4, Class II) and with a rated output of 5.0 VDC, 1.0 A Max must be used to charge this device.
- Do not plug this device into a voltage system that is different from the voltage system specified on the device or charger.
- Do not expose the appliance or battery to excessive temperatures.
- Keep the charging cord and user supplied USB wall charger away from heated surfaces.
- Do not expose the appliance or battery to excessive temperatures.
- Unplug USB wall charger when not in use.
- Do not use the Water Flosser for more than five minutes in each two hour period.
- Do not direct water under the tongue, into the ear, nose or other delicate areas. This product is capable of producing pressures that may cause serious damage in these areas. The potentially deadly amoeba, Naegleria fowleri, may be present in some tap water or unchlorinated well water and may be fatal if directed into the nose or ear.













- If your physician advised you to receive antibiotic premedication before dental procedures, you should consult your dental professional before using this product or any other oral hygiene aid.
- Fill reservoir with warm water or other dental professional recommended solutions only.
- Do not use iodine, saline (salt solution), or water insoluble concentrated essential oils in this product. Use of these can reduce performance and will shorten the life of the product.
- Only use tips and accessories that are recommended by Water Pik, Inc.
- If the Pik Pocket™ tip (not included in all models) separates from the shaft for any reason, discard tip and shaft and replace with a new Pik Pocket™ tip.
- Do not drop or insert any foreign object into any opening on the product.
- Do not use this product outdoors or operate where aerosol (spray) products are being used or where oxygen is being administered.
- Remove any oral jewelry prior to use of this product.
- Do not use if you have an open wound on your tongue or in your mouth.
- There are no consumer serviceable electrical parts in this product and it does not require maintenance.
- Remove charging cord from the unit and replace charging port cover prior to filling the reservoir.
- This appliance can be used by children aged from 8 years and above and persons with reduced physical, sensory or mental capabilities or lack of experience and knowledge if they have been given supervision or instruction concerning use of the appliance in a safe way and understand the hazards involved.
- Children shall not play with the appliance. Cleaning and user maintenance shall not be made by children without supervision.
- If the supply cord is damaged, it must be replaced by a special cord or assembly available from the manufacturer or its service agent.
- Do not use this product if it has a damaged cord or plug, if it is not working properly, if it has been dropped or damaged, or dropped into any liquid. Contact Water Pik, Inc. at +44 (0) 333 123 5677 or visit [www.waterpik.co.uk](http://www.waterpik.co.uk).

## SAVE THESE INSTRUCTIONS

Product Description	5
Getting Started	6
Cleaning and Troubleshooting Your Waterpik® Water Flosser	9
Battery Removal	10
Limited Two-Year Warranty	11

## SYMBOLS

The following symbols may appear on your product and/or packaging. Some of these symbols may not be relevant in your region and are listed for information purposes only.

Symbol	Definition	Symbol	Definition	Symbol	Definition	Symbol	Definition
	Refer to instruction manual		Detachable Power Supply		Do not use this device in a shower, bathtub and do not immerse in any liquid.		Regulatory Compliance Mark
	Manufacturer		Direct Current (DC) Voltage		Authorized Representative in the European Community		Separate collection for waste electrical and electronic equipment.
IPX7 or IPX4	Ingress Protection Code		Alternating Current (AC) Voltage		CE marking of conformity		
	IEC Class II Equipment		Do not immerse this device in any liquid.		UK Conformity Assessed		

1. Power/Mode button
2. LED mode indicators
3. Battery charge indicator
4. Tip
5. Tip eject button
6. Reservoir
7. Reservoir fill door



USB Charging Cable  
20030405-1 White  
WF-16/WF-17

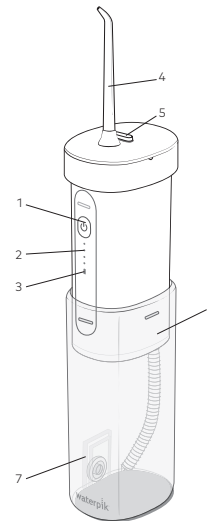

## TIPS

- A. Orthodontic Tip\***  
- Braces/General use
- B. Pik Pocket™ Tip\***  
- Periodontal Pockets/Furcations
- C. Plaque Seeker™ Tip\***  
- Implants/Crowns/Bridges/Retainers/General use
- D. Toothbrush Tip\***  
- General use
- E. Classic Jet Tip\*\***  
- General use
- F. Tongue Cleaner\*\***  
- Fresher breath
- G. Water Spill Over Protection**  
- Keeps excess water from draining out while traveling

## NOT ALL TIPS INCLUDED IN ALL MODELS

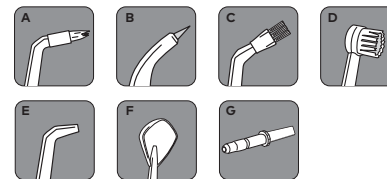

\*Replace Every 3 months \*\*Replace Every 6 months

Replacement tips/attachments may be purchased online at [www.waterpik.co.uk](http://www.waterpik.co.uk), or by phone from Water Pik, Inc. at +44 (0) 333 123 5677. To find detailed information about tips, other accessories, and product usage please visit our website at [www.waterpik.co.uk](http://www.waterpik.co.uk).

## GETTING STARTED

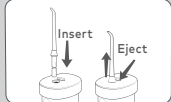
**Charging Unit Prior to First Use**

Charge unit for approximately 4 hours prior to first use. Plug the user supplied USB wall charger into a wall outlet and connect the charging cable to the unit (see images). Refer to the *Important Safeguards* section for required USB wall charger specifications.

**Ensure contacts on BOTH the cord and the unit are clean and dry, and the reservoir is empty and collapsed.** The LED light will emit a slow glow on/off when unit is charging. Once the unit is fully charged and the charger is connected the LED will remain on until the charger is disconnected. A full charge will last up to 4 weeks of typical use (using 1 reservoir per day). When the batteries are in need of charging (approximately 30% charge left) the charge indicator light will emit a rapid triple blink during and after use to indicate that you should recharge the unit.

A complete recharge will take 3-4 hours. If you use your Water Flosser once a day or less, it is recommended you charge every 3-4 weeks. If you use it twice a day or more, charge more frequently.

Put the protective USB plug back into place before use. The plug should only be removed for charging

**Filling the Reservoir**

Remove the charging cable from the unit and replace charging port cover prior to filling reservoir and product use. Pull down on reservoir to open. Unit will "click" into place when fully extended. Lift flip top on reservoir and fill the reservoir with lukewarm water.

Collapse by pushing reservoir up. Reservoir will "click" into place when fully closed.

**Inserting and Removing Tips**

Insert tip at the top of the unit. Press firmly until the tip clicks into place. To remove the tip from the unit, press the tip eject button and pull tip from the unit.

**CAUTION: Do not press tip eject button while unit is running.**

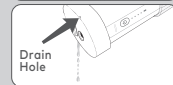
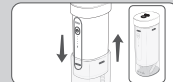
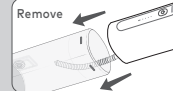
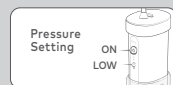
**Adjusting the Pressure Setting**

- 3 modes - low, med, high pressure settings.
- Unit will remember last setting when turned off (press and hold if within five seconds of turn on, short press after running for more than five seconds).
- Unit will cycle through the modes when the button is repeatedly pressed within five seconds of turn on.

**Recommended Technique**

Lean low over sink and place tip in mouth. Aim the tip toward gumline, and turn the unit ON. Start on the lowest setting and increase to your liking.

For best results, start with the back teeth and work toward the front teeth. Glide tip along gumline and pause briefly between teeth. Continue until you have cleaned the inside and outside of both the upper and lower teeth.

Direct the jet stream at a 90-degree angle to your gumline. **Slightly close lips to avoid splashing** but allow water to flow freely from mouth into the sink. Keep unit upright during use for best results.

**When Finished**

Turn the unit OFF. Empty any liquid left in the reservoir. If desired, the reservoir may be removed from the power handle by simply pulling down on the reservoir to remove.

Drain unit after use to prevent residual water from leaking out. Tilt unit on it's side and allow water to drain from the drain holes at the top.

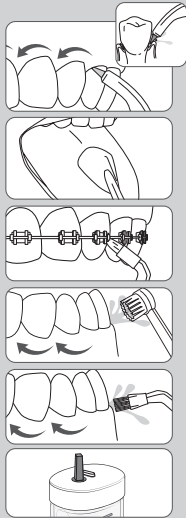

**NOTE: NOT ALL TIPS INCLUDED WITH ALL MODELS.**

#### TIP USAGE

##### **Pik Pocket™ Tip**

The Pik Pocket™ tip is specifically designed to deliver water or anti-bacterial solutions deep into periodontal pockets. To use the Pik Pocket™ tip, set the unit to the lowest pressure setting. Place the soft tip against a tooth at a 45-degree angle and gently place the tip under the gumline, into the pocket.

##### **Tongue Cleaner Tip**

Set to lowest pressure setting, place tip in the center/middle of your tongue about half way back. Pull forward with light pressure. Increase pressure as you prefer.

##### **Orthodontic Tip**

To use the orthodontic tip, gently glide tip along gumline, pausing briefly to lightly brush area between teeth and all around orthodontic bracket, before proceeding to the next tooth.

##### **Toothbrush Tip**

Place the toothbrush tip in mouth with the brush head on the tooth at the gumline. The toothbrush tip can be used with or without toothpaste. Using a light pressure (bristles should not bend) massage the brush back and forth with very short strokes – much like you would with a manual toothbrush.

##### **Plaque Seeker™ Tip**

To use the Plaque Seeker™ tip, place the tip close to the teeth so that the bristles are gently touching the teeth. Gently glide tip along gumline, pausing briefly between teeth to gently brush and allow the water to flow between the teeth.

##### **Water Spillover Protection**

When travelling, place water spillover protection plug in unit to keep excess water from draining out.

NOTE: Do NOT run unit while water spillover protection plug is in unit.

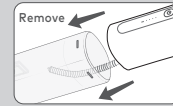

#### Using Mouthwash and Other Solutions

Your Waterpik® Water Flosser can be used to deliver mouthwash and antibacterial solutions. If you are adding additional water you may replace the reservoir and fill reservoir. After using any special solution, rinse unit.

#### Cleaning

**Never immerse unit in water.** Before cleaning, unplug from the electrical outlet. Clean the product when necessary by using a soft cloth and mild nonabrasive cleanser to wipe exterior. The water reservoir is removable for easy cleaning. It is recommended that the reservoir is removed and cleaned weekly.

#### Removing Hard Water Deposits / General Cleaning

Hard water deposits may build up in your unit, depending on the mineral content of your water. If left unattended, it can hinder performance. Cleaning internal parts: add 1 tablespoon of white vinegar to a full reservoir of warm water. Point the handle and tip into sink. Turn unit ON and run until reservoir is empty. Rinse by repeating with a full reservoir of clean warm water. This process should be done every 1 to 3 months to ensure optimal performance.

#### Battery Care and Disposal

If the Water Flosser is to be stored for an extended period of time (six months or more), be sure to fully charge it prior to storage. The unit contains a rechargeable lithium-ion battery. At the end of the battery life, please recycle the unit at your nearest recycle center per local or state requirements. The battery is not replaceable.

### Battery Recycling

**WARNING:** The battery of this product is not replaceable. Please do not disassemble the product unless you want to dispose it. Otherwise the warranty service will be void.

This product contains a **rechargeable lithium-ion battery** and electronic waste. In order to protect the environment, please do not dispose along with household waste. When the battery life ends, please recycle according to local administrative regulations. Please contact local waste administrative department for any questions.

### Battery Removal Instructions:

If you intend to dispose of the battery on your own, please follow the BATTERY REMOVAL INSTRUCTIONS to remove the rechargeable lithium-ion battery. Contact your local waste administrative department with any questions.

1. The power should be off and the battery fully discharged before removal. It may take several power cycles before the battery is fully discharged.
2. Cut off top of unit.
3. Slide battery out of chassis. Cut wires individually (avoid cutting positive and negative at the same time to prevent shorting).

The removed battery should be disposed safely by special recycling center.

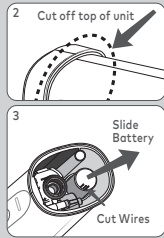

### Service Maintenance

Waterpik® Water Flossers have no consumer serviceable electrical items and do not require routine service maintenance. For all your service needs please call the Water Pik, Inc. UK Customer Service Centre at +44 (0) 333 123 5677. Some replacement parts and accessories for the Water Flosser are also available at [www.waterpik.co.uk](http://www.waterpik.co.uk).

For questions or problems please call the customer service centre before returning the product.

Refer to the serial and model numbers in all correspondence. These numbers are located on the back of the handle and bottom of the reservoir respectively.

Still have questions? Go to [www.waterpik.co.uk](http://www.waterpik.co.uk).

### Warranty

Water Pik, Inc. warrants to the original consumer of this new product that it is free from defects in materials and workmanship for 2 years from the date of purchase.

Consumer will be required to submit the original purchase receipt as proof of purchase date and if requested, the entire product, to support a warranty claim. Water Pik, Inc. will replace at its discretion the product, which in its opinion is defective, provided the product has not been abused, misused, altered or damaged after purchase, was used according to instructions, and was used only with accessories or consumable parts approved by Water Pik, Inc. This limited warranty excludes accessories or consumable parts such as tips, etc.

This warranty gives you specific legal rights. You may also have other rights that vary, depending on the law in your place of residence.

# waterpik®

**Water Pik, Inc., a subsidiary  
of Church & Dwight Co., Inc.**  
1730 East Prospect Road  
Fort Collins, CO 80553-0001 USA  
844-821-4873  
[www.waterpik.com](http://www.waterpik.com)



EC REP



SOFIBEL SAS  
110-114 rue Victor Hugo  
92686 Levallois-Perret  
France



UK Responsible Person  
Church & Dwight UK Limited,  
Wear Bay Road,  
Folkestone,  
Kent CT19 6PG  
United Kingdom

Designed and tested in the USA. Made in China.

Form No. 20032291-F AA

©2023 Water Pik, Inc.