

# waterpik® waterflosser®

## QUICK START GUIDE Ultra Professional 600 Series

### 1 First Use

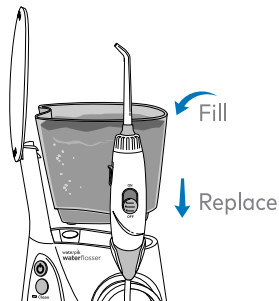

Fill reservoir with warm water and replace it firmly on the base.

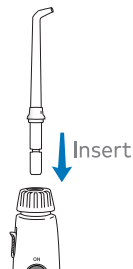

Insert tip firmly until it clicks into place.

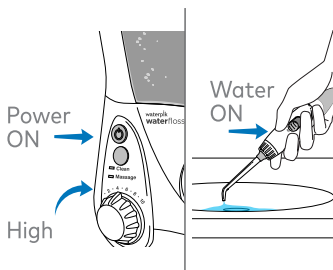

Turn pressure to high, point tip into sink, turn power on and water switch to **ON** until water flows. Turn **OFF**.

# waterpik® waterflosser®

## QUICK START GUIDE Ultra Professional 600 Series

### 2 Water Floss

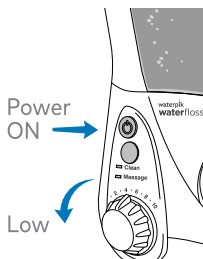

With power **OFF** and water switch in **OFF** position, place tip in mouth. Turn power **ON**. Turn water switch to **ON**.

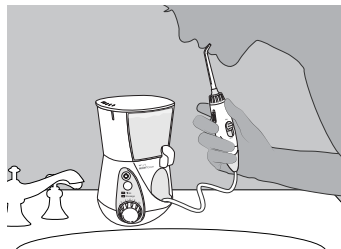
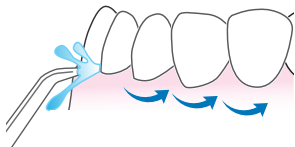

Lean over sink. Close lips enough to prevent splashing, while still allowing water to flow from mouth into sink. Start on low pressure and increase to your liking.

Aim water at the gumline at a 90 degree angle. Follow the gumline and pause briefly between teeth.

**TO AVOID MESS: KEEP TIP IN MOUTH WHILE UNIT IS ON.**